

EN

WYBOT

ROBOTIC POOL CLEANER

User Manual

Osprey 200

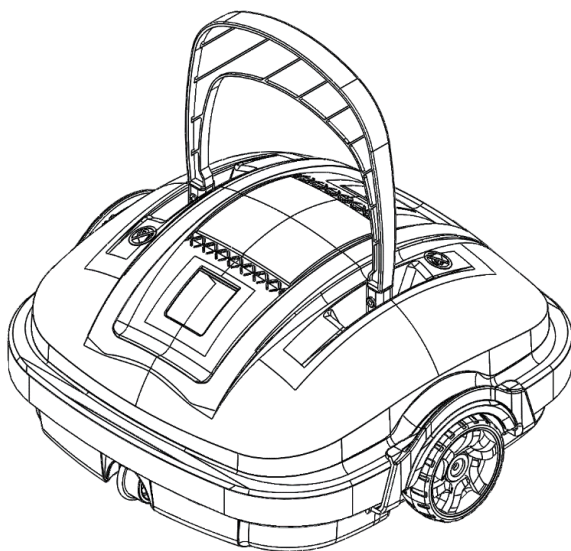

Thank you for purchasing Wybot™ Robotic Pool Cleaner. Please read through the entire manual before using your new robotic pool cleaner. We are not held liable for any loss or injury caused by improper use. If you encounter a problem with your Wybot™ product, please contact our customer service for assistance.

WYBOT Customer Service:

Email: support@wybotpool.com

Web: www.wybotpool.com

Facebook: [@WybotPool](https://www.facebook.com/WybotPool)

WYBOT™

CONTENTS

IMPORTANT SAFETY INSTRUCTIONS.....	2
1. Introduction	3
2. Packing List.....	3
3. Product Diagram	3
4. Specifications	4
5. Operation Instructions	5
5.1 Assembly before use.....	5
5.2 To use the robotic cleaner	6
5.3 Clean after use.....	8
5.4 To adjust the running pattern	9
6. Buzzer Note	10
7. Trouble Shootings	10
8. Warranty	12

IMPORTANT SAFETY INSTRUCTIONS

READ AND FOLLOW ALL INSTRUCTIONS

1. Read the manual carefully, and use the cleaner according to the manual. We are not liable for any loss or injury caused by improper use.
2. Only use the accessories recommended or sold by the manufacturer.
3. This model only applies to swimming pools with a flat floor.
4. Do not allow children to ride on the cleaner or play with it as a toy.
5. Use the original and authorized charging adapter only.
6. The adapter cord should only be repaired or replaced by a qualified electrician.
7. Do not turn on the cleaner when it is out of water.
8. The charging adapter must be connected to a leakage protected and earthed socket when charging.
9. Do not operate the cleaner when there are people in the pool.
10. Always clean and wash the filter tray after use.
11. Turn off the cleaner when maintaining, cleaning or when it is not in use.
12. The cleaner should be stored in a cool and ventilated place, away from direct sunshine.
13. While charging, the cleaner should be kept in a cool place, and not be covered with anything to prevent the damage of internal electrical components caused by overheating.
14. Only certified professionals can disassemble the sealed driving kit of the cleaner.
15. Do not operate the cleaner while pool filter is running.
16. Oil seals for motor contain grease, which may cause water pollution if grease leaks occur.
17. Due to the limitation of battery capacity, the cleaner is only suitable for swimming pools with size up to 525 ft² (50m²), otherwise the cleaning effect will be affected.
18. When the cleaner is stored for a long period of time, it should be charged every six months to maintain battery life. Please use the original and authorized charging adapter only. If the cleaner is not charged for a long time, the battery voltage will be lower than the over-discharge protection voltage due to the self-discharge of the battery, which may cause fatal damage.
19. Do not use or store the cleaner near any heat source.
20. Do not pierce the shell of the cleaner with nails or other sharp objects. Do not hammer, impact, or throw the cleaner.
21. Make sure the charging socket is dry before charging.

SAVE THESE INSTRUCTIONS

1. Introduction

The environmentally-friendly robotic pool cleaner Osprey 200 is a new type of rechargeable automatic cleaner that filters the pool water and gets rid of particles without replacing the pool water.

2. Packing List

Item	Name	QTY (pc/pcs)	Remark
1	Cleaner	1	In carton
2	Charger	1	In carton
3	Flipper	1	In carton
4	Retrieving Hook	1	In carton
5	Screw	2	In plastic bag
6	Scraper	2	In plastic bag
7	User Manual	1	In plastic bag
8	Quick Guide	1	In carton

3. Product Diagram

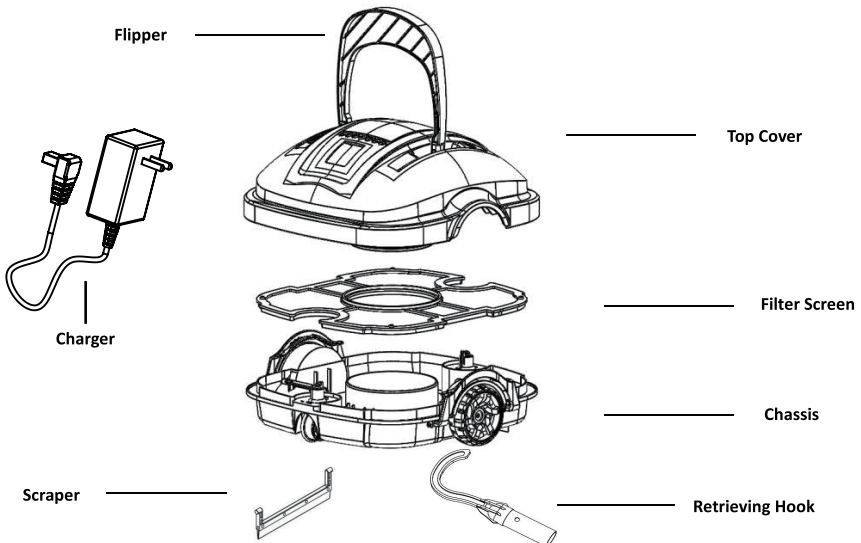

4. Specifications

Product Name	WYBOT Robotic Pool Cleaner
Model	Osprey 200
Rated Working Voltage	11.1V
Power	approx. 30W
Working Cycle	max. 60mins
Rated Input Voltage of Adapter	100Vac-240Vac
Rated Input Frequency of Adapter	47Hz-63Hz
Rated Output Voltage of Adapter	12.6Vdc
Rated Output Current of Adapter	1A
Battery Capacity	2600mAh
Charging Time	3-4 H
Cleaning Surface	max. 525ft ² / 50m ²
Filter Capability	approx. 32gal/min (120L/min)
Filter Density	180μm
Moving Speed	approx. 52.5ft/min (16m/min)
Water Depth	max. 8.2 ft / 2.5m
IP Grade	IPX8
Pool Water Temperature	50°F-95°F / 10°C-35°C
Charging Environment Temperature	41°F-95°F / 5°C-35°C
Storage Temperature	41°F-95°F / 5°C-35°C
Product Weight	7.9 lb / 3.6kg
Product Size	13.4 (L) * 13.8 (W) * 13.0 (H) in / 340 (L) * 350 (W) * 330 (H) mm

5. Operation Instructions

5.1 Assembly before use

1. Attach the flipper and fix it with the screws provided.

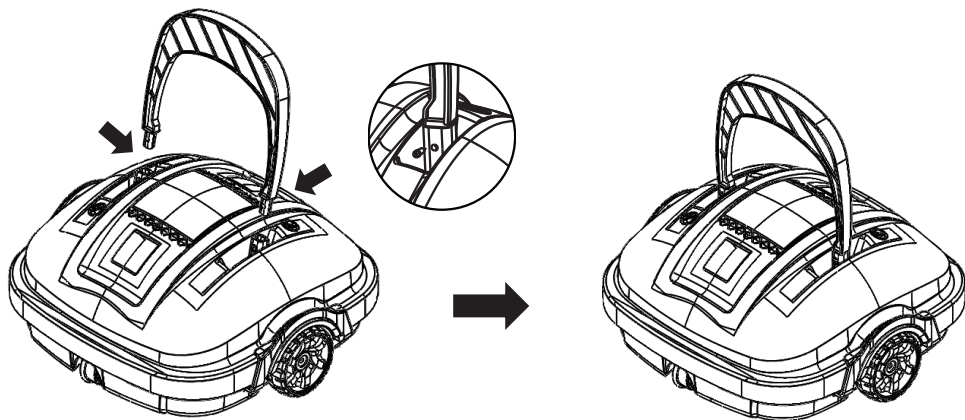

Note: The installation direction of 2 screws is opposite.

2. Install the scrapers to enhance suction effect if the pool floor is full of debris or particles. It is not recommended to install the scrapers if the pool bottom is uneven or full of pits, which avoids the cleaner from getting stuck by the rough floor.

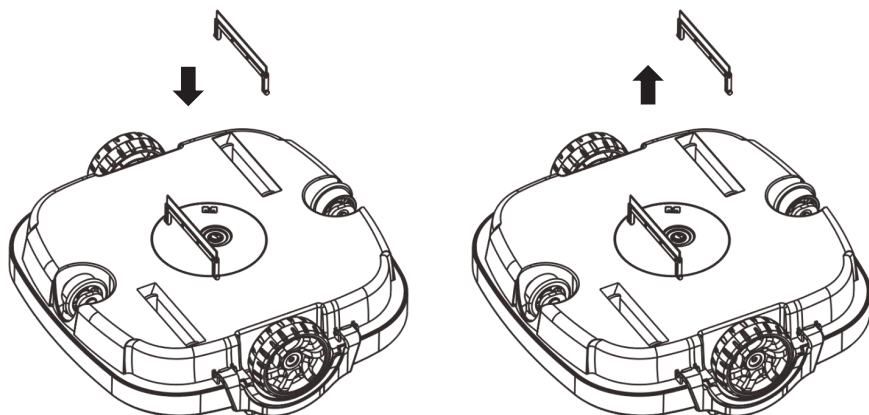

3. Attach the retrieving hook to a standard pool pole (not included).

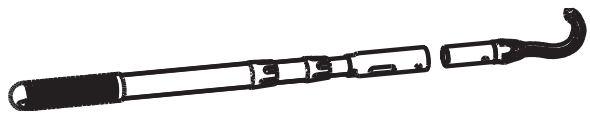

5.2 To use the robotic cleaner

1. Charge the battery

Fully charge the cleaner before each use. Attach the charging connector to the charging socket at the bottom of the cleaner. Place the cleaner in its upright position and, then plug the charger into the main electrical outlet. The indicator lamp on the charger shall turn red when charging. It should turn green once fully charged.

NOTE: The robotic cleaner must be charged indoor.

NOTE: It is strictly forbidden to face the bottom up to prevent the swing plate from being crushed when charging.

NOTE: Clean and dry the charging socket before charging.

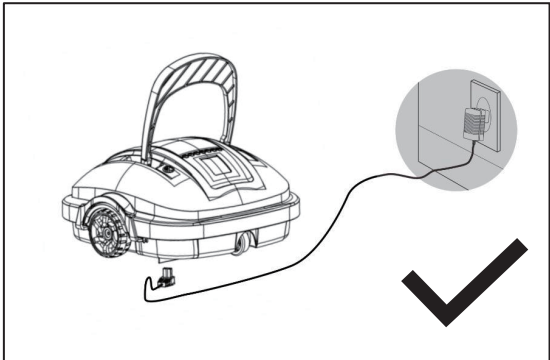
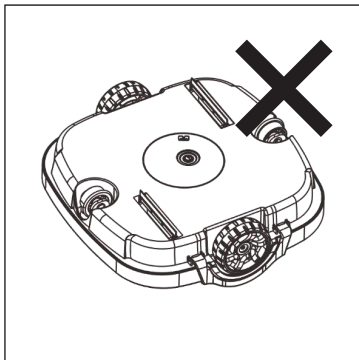
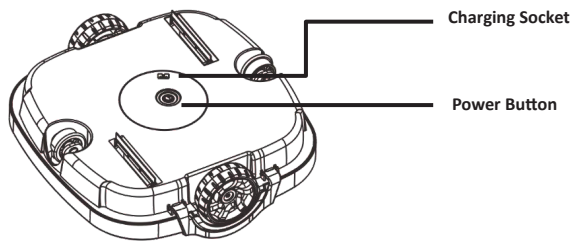

2. Purge out the air

Hold the robotic cleaner with two hands and submerge it into the pool. Rotate the cleaner until no air bubble is coming out.

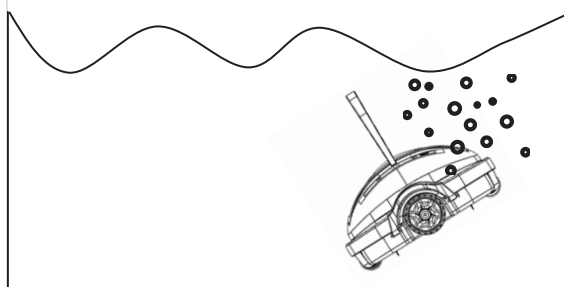

3. Turn on the power

While keeping the entire robotic cleaner underwater, switch on the product by pressing the power button located at the bottom. Water will begin to flow out from the nozzle after 5 seconds.

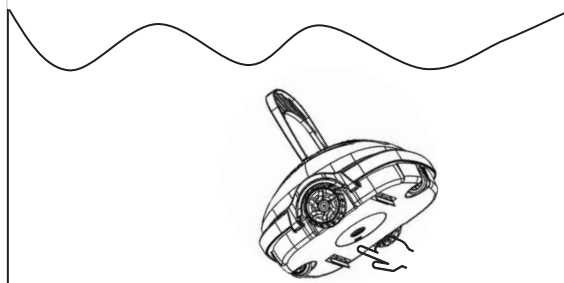

4. Release the cleaner

Hold the robotic cleaner in its upright position and slowly release the product. The product shall slowly sink to the pool floor. In case the cleaner is flipped upside down, use the floating handle to correct its orientation.

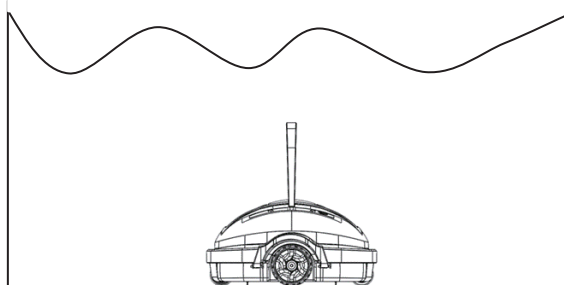

5. Let it clean

The robotic cleaner shall run around the pool floor and vacuum the debris automatically for max. 60 minutes. It will automatically reverse when it touches the wall. The cleaner will move to the pool wall automatically and stop running when it runs out of battery.

6. Retrieve the cleaner

To retrieve the robot, grasp the flipper and pull it out of the water and away from the pool. Power off the robot. Use the retrieving hook if needed.

5.3 Clean after use

1. Open all lock buckles, detach the top cover, and remove the filter screen.

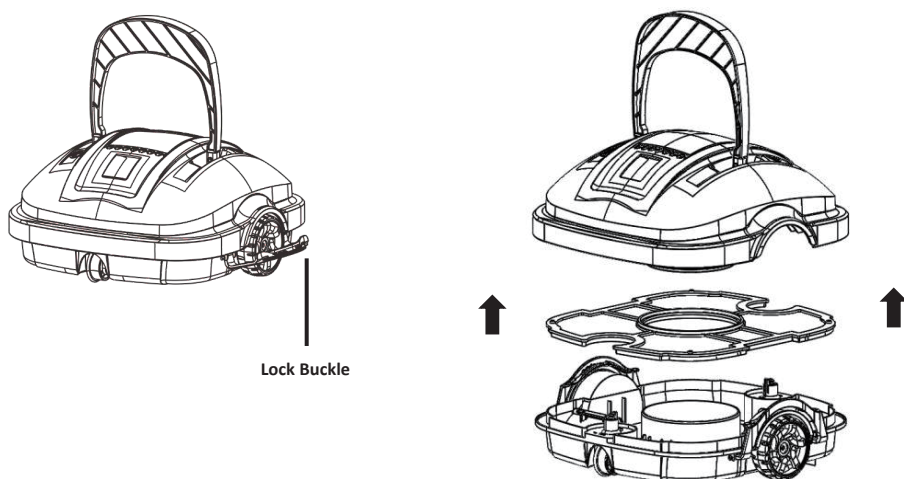

2. Rinse off all the dirt and debris with running water.

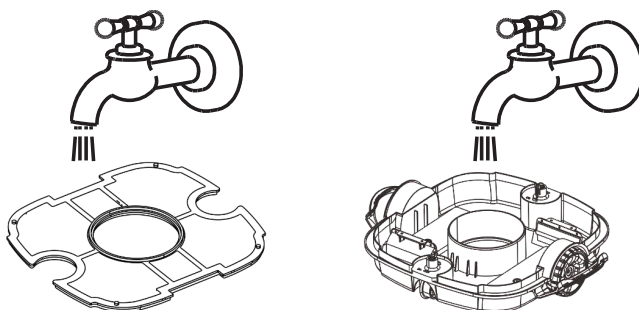

3. Wipe the robotic cleaner with a clean cloth and let it air dry.

5.4 To adjust the running pattern

1. This robotic cleaner comes with 2 adjustable wheels. By modifying the combination of these 2 adjustable wheels, it will change the running pattern of the cleaner.

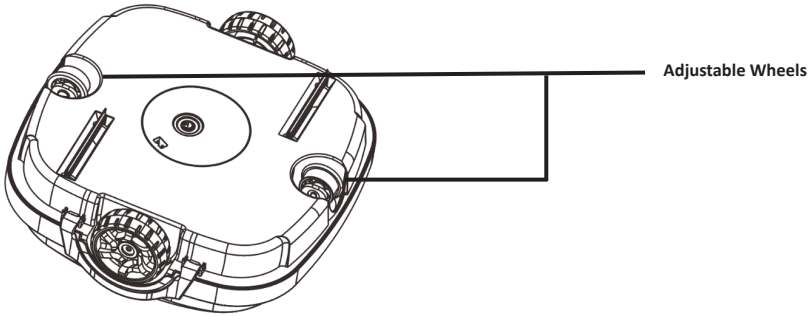

2. To adjust the wheel, open the lock buckles and remove the top cover. Locate the 2 adjustable wheels. Detach the wheel by pushing the wheel stem catch. Select the correct combination and insert the wheel until the catch clicks.

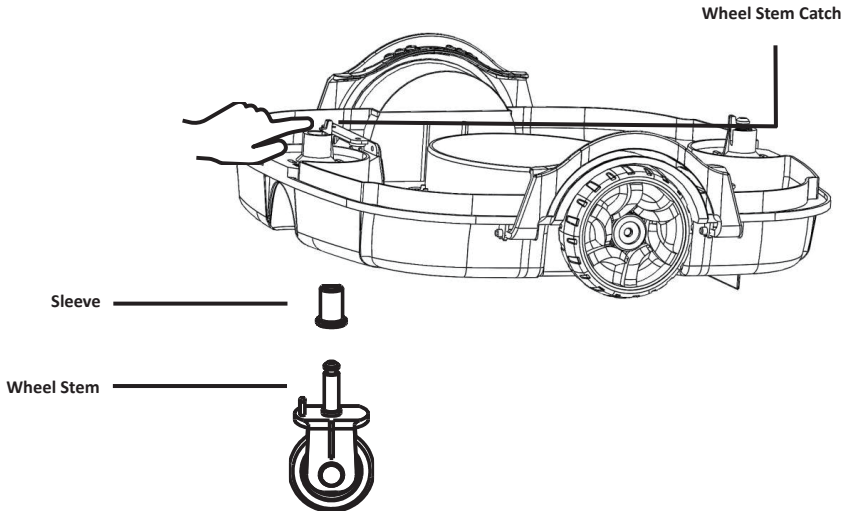

3. Combinations:

A – C for most types of pool (factory setting)

B – C Smaller rebounding angle than A – C

C – C Minimum maneuvering (For rectangular or longer pool)

A – B For round pools

Combination B-A

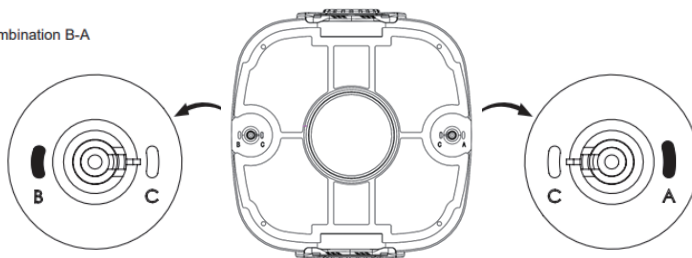

6. Buzzer Note

Status	Description
Power on	Beep before not fully immersed in the water; Stop beeping after fully immersed in the water
Power off	Stop beeping

7. Trouble Shootings

Issue	Scenario	Possible reason	Solution
The buzzer does not beep, or the impeller does not work when the cleaner is out of water.	-----	Battery level is low.	Recharge the battery.
	-----	Internal fault	Call customer service
The buzzer still beeps, or the impeller does not work when the cleaner is in the water.	Internal fault	Internal fault	Call customer service

The cleaner does not change direction when hitting the pool wall.	The flipper does not flip forward when approaching the pool wall	The flipper is stuck and does not turn freely.	Hose off the dirt around the hinge of the flipper. Make sure the flipper turns freely.
The LED indicator does not light up when the charger is plugged in.	-----	Faulty charger	Call customer service and request for a replacement charger.
The cleaner does not vacuum the entire pool floor.	The cleaner keeps bouncing at the same direction, some areas are always missed.	Improper running pattern setting	Try different running patterns. Refer to the “To adjust the running pattern” section of the manual.
		Irregular pool shape	
	The pool filter is on.	Water current inside the pool affects the running of the cleaner.	Turn off the pool’s filter pump when using this product.

8.Warranty

1. This product is covered by Wybot™ warranty for 24 months (only for driving kit and control box kit) from the date of purchase. Consumable parts are beyond warranty which include Filter Tray/ Brush/ Wheels/Nozzles.
2. This warranty is voided if the product has been altered, misused, or has been repaired by unauthorized personnels.
3. The warranty extends only to manufacturing defects and does not cover any damage resulting from mishandling of the product by the owner.
4. The order number or record must be presented for any claim or repair during the warranty period.

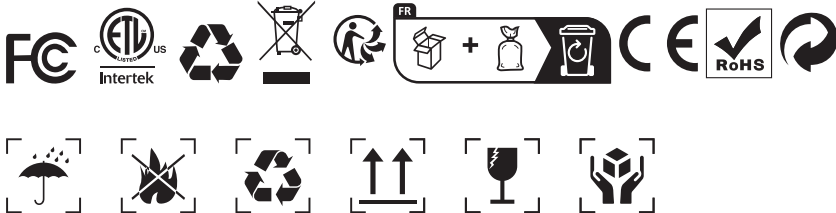

Environmental Programmes, WEEE European Directive



Please respect the European Union regulations and help to protect the environment.

Return non-working electrical equipment to a facility appointed by your municipality that properly recycles electrical and electronic equipment. Do not dispose them in unsorted waste bins.

For items containing removable batteries, remove batteries before disposing of the product.